

Steam Bath Controller - User Manual

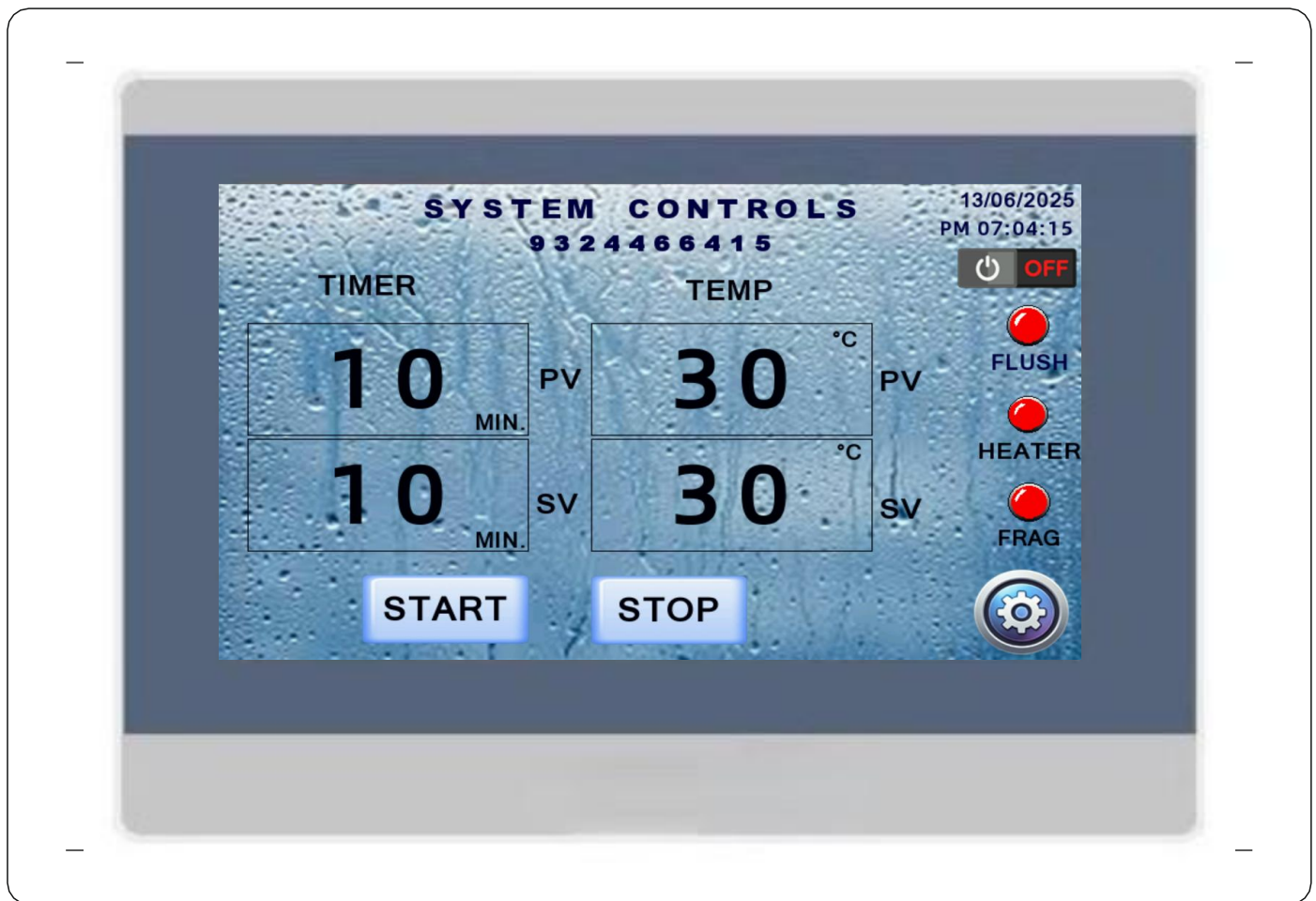

Display Specification:

Display	4.3"16:9 TFT LCD Screen	7.0"16:9 TFT LCD Screen
Resolution	800 X 480	800 X 480
Color	16 Bit	16 Bit
Brightness	250 CD/m ²	250 CD/m ²
Backlight	LED	
Touch Screen	4-line industrial resistive HMI	
LCD Life	50000 Hours	

Wiring Connection of 4.3" HMI:

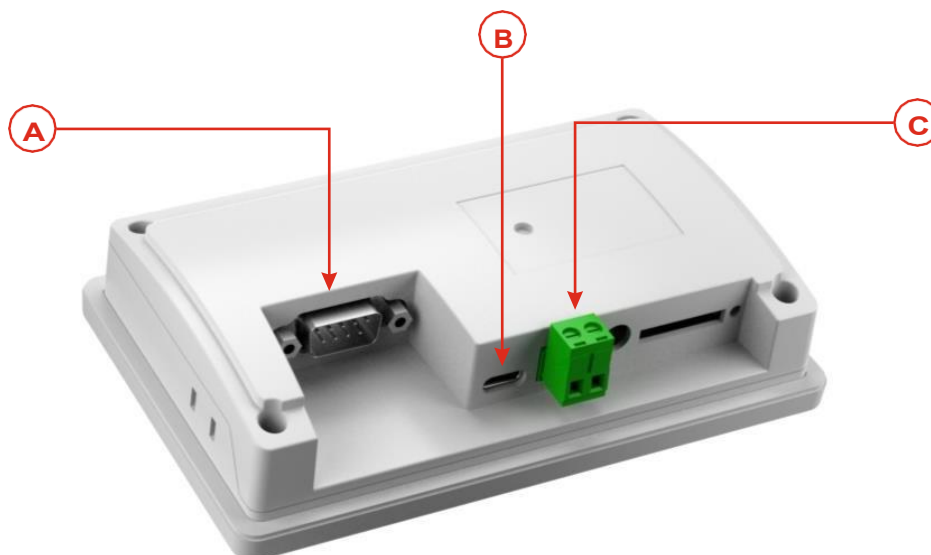

Sr.No	Connection	Discription
A	DB 9 Connector	For Device Communication & Printing
B	USB Type C	For Downloading Program & to Copy Data In Pendrive
C	Power Terminal	Pin 1 - 0V Pin 2 - DC 24V

Mechanical Dimensions of 4.3" HMI:

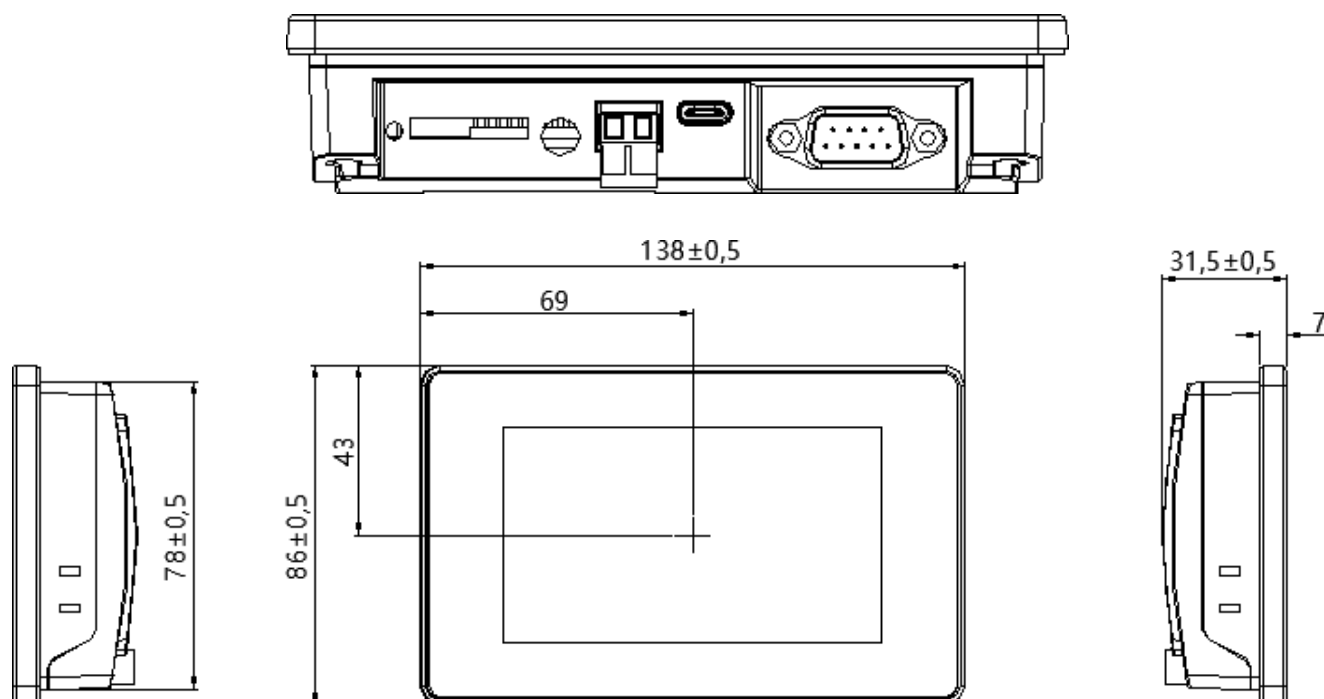

Wiring Connection of 7.0" HMI:

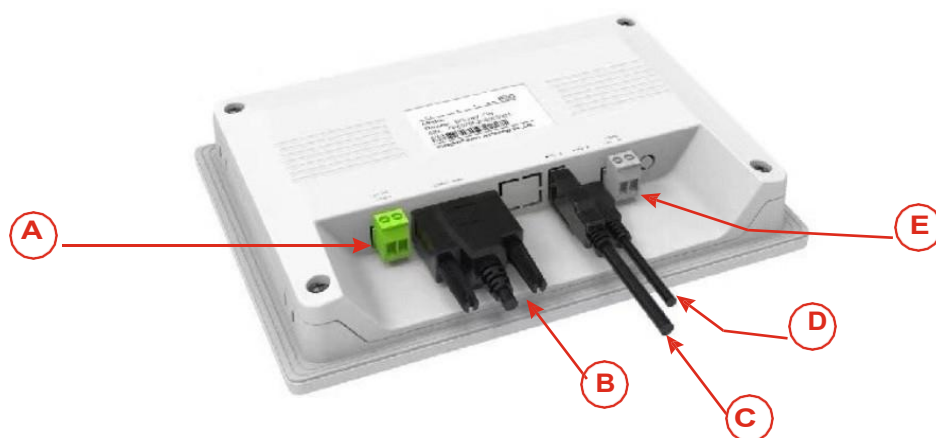



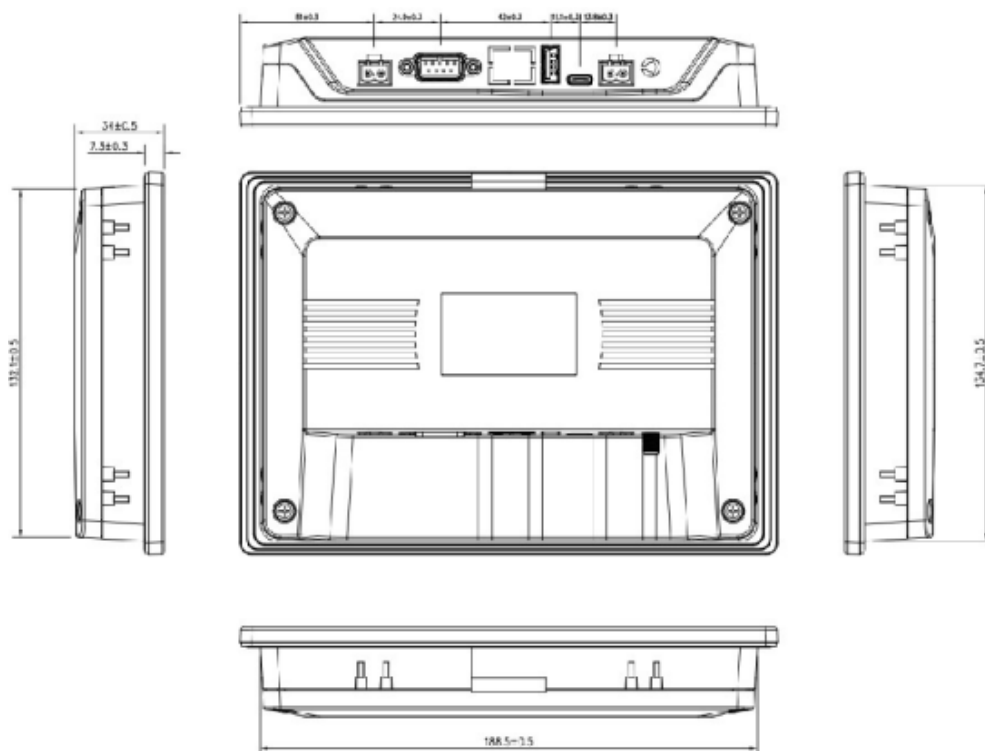

Sr.No	Connection	Discription
A	Power Terminal (COM1/COM3)	Pin 1 - (-DC GND) Pin 2 - (+DC 24 V)
B	DB 9 Connector	For Device Communication & Printing
C	USB Host	Connecting U-DISC and Scanner etc.
D	USB Slave	For Downloading Program
E	485 Terminal (COM2)	Pin 1 - A+ (+RS-485) Pin 2 - B- (-RS-485)

Mechanical Dimensions of 7.0" HMI:

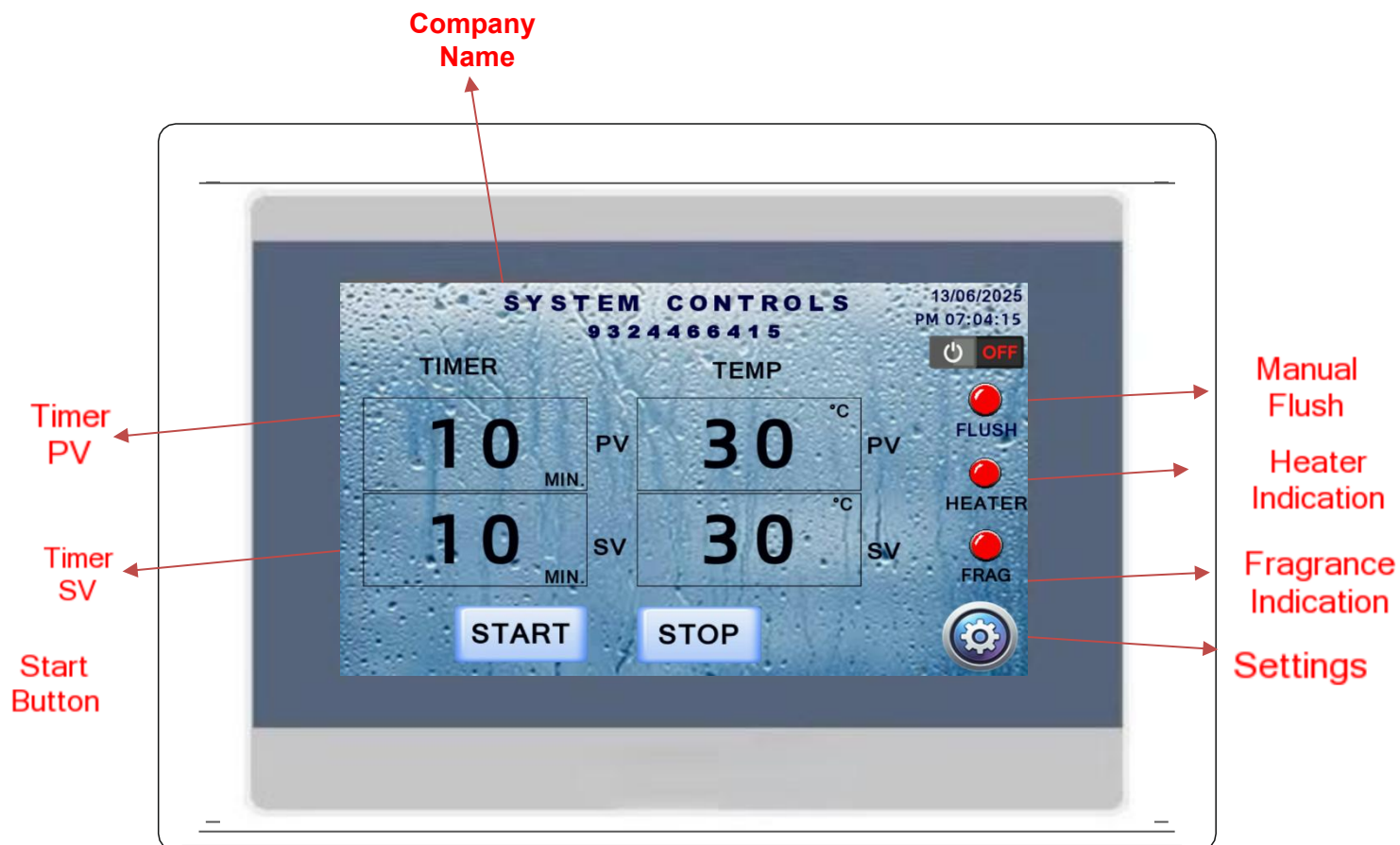

Home Screen:



1.		Output Indication: You can observe output indication such as heater or boiler.
2.		Settings: Click this icon to Device Settings.
3.		Output Indication: You can observe output indication of fragrance.
4.		Start Button

5.		Stop Button
6.	<div>PV</div> <div>SV</div>	PV: PV Stands for process value SV: SV Stands for set value.

Password

Access Level	Access Level
Password	15

1. Auto-Fragrance:



- **ON Time:** Set the duration (in seconds) for which the fragrance dispenser stays ON (releasing fragrance).
- **OFF Time:** Set the duration (in seconds) for which the dispenser stays OFF (no fragrance release).

2. Auto-Drain:

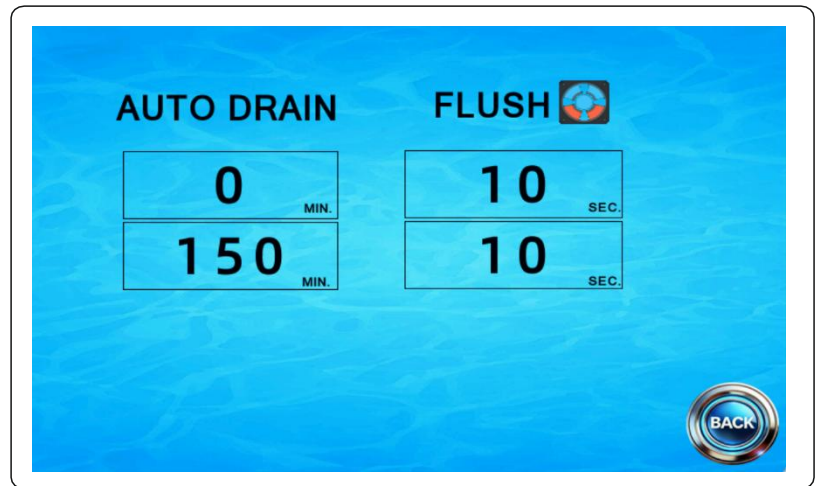
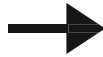
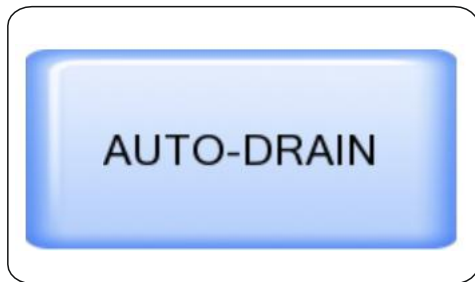

Auto Drain Timer (Steam Bath Controller)

- **Auto Drain Time:** Set the duration (in minutes) after which the system will automatically drain the water if unused.

Example:

If you set the Auto Drain Time to 180 minutes (3 hours), and no water usage is detected during this period, the system will automatically drain the stagnant water to ensure hygiene and prevent scaling.

3. Flush:

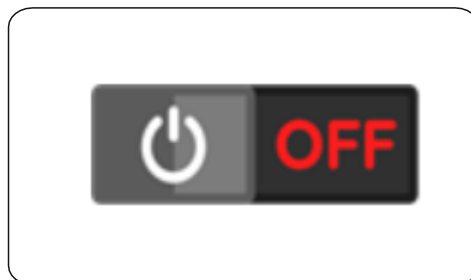

Manual Flush (Steam Bath Controller)

You can set the flush duration in seconds. Press the button to activate the flush manually.

4. Device Settings:

**CONTROL
SETTINGS**



DEVICE INFORMATION

COMPANY NAME : 

CONTACT : 

INSTRUMENT :

LOCATION :



5. Real Time Clock:

**REAL TIME
CLOCK**

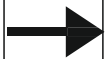

RTC DATE

7 / 6 / 2025

14 : 55 : 18



6. Popup Windows

a. Panic Button Popup:

PANIC BUTTON



OK

b. Sensor Open Popup:

SENSOR OPEN



OK

7. Connection Diagram:

